

PassKey Authentication Method Logging

Use this QRG for using the PassKey authentication method to login.

Introduction:

Passkey is a modern, password less sign-in method that replaces traditional passwords with cryptographic keys. Instead of typing a password, users authenticate using their devices such as a fingerprint, face recognition, or a device PIN.

Passkey Configuration

1. On “My Profile” menu, the “Authentication Methods” link can display the PassKey methods.

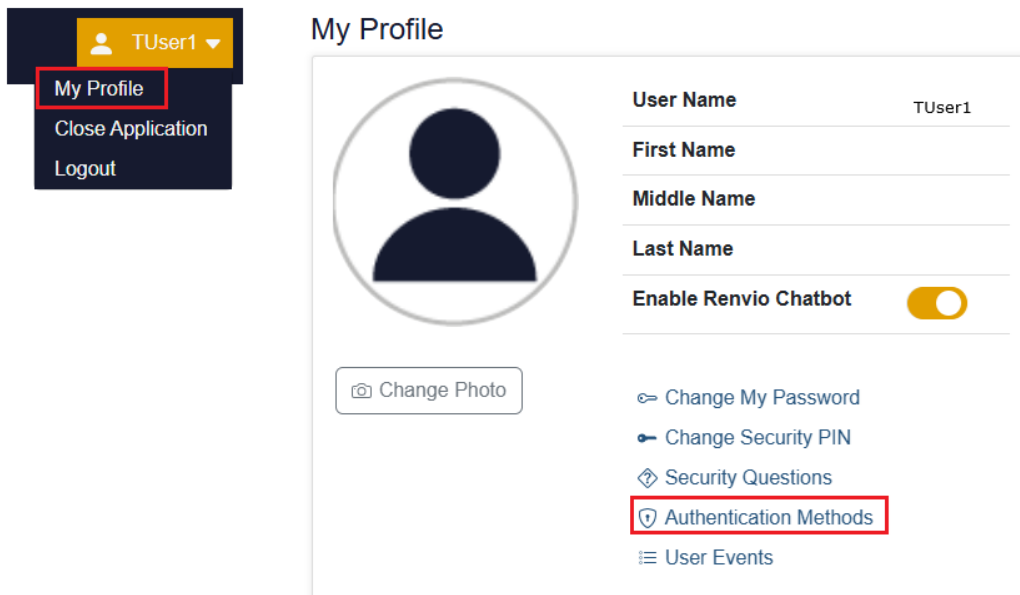

2. Validate the user credentials and click in “Verify” button.

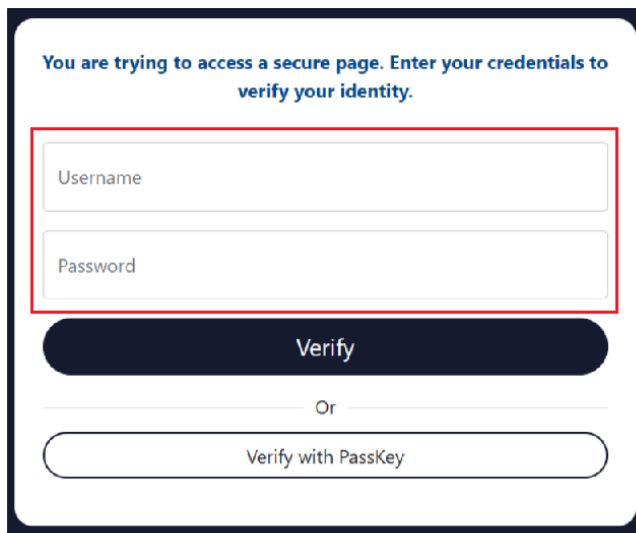

3. Click on the “Add” button inside of the “Manage PassKeys” grid view.

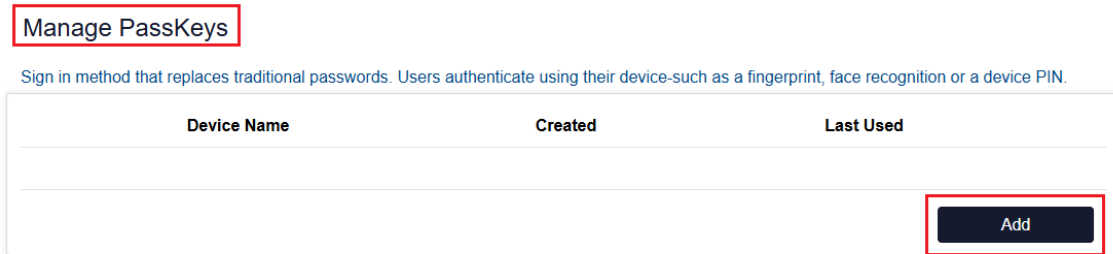

4. Insert a “Device Name” and click on “Register Passkey”

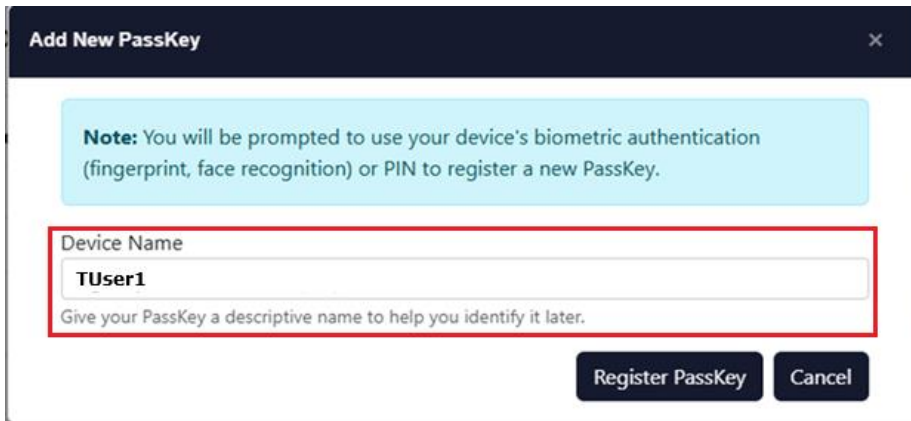

5. Click on “User another device” since a smartphone is the recommended device for a Passkey

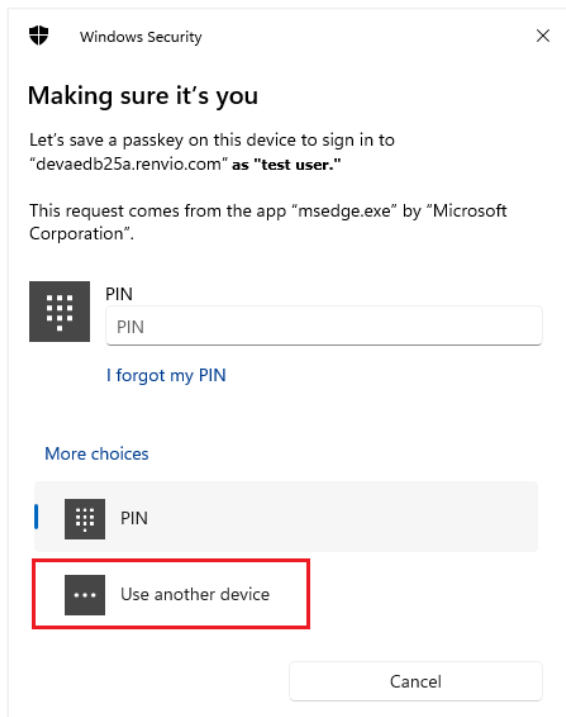

6. Click on “Next” button to display a QR Code

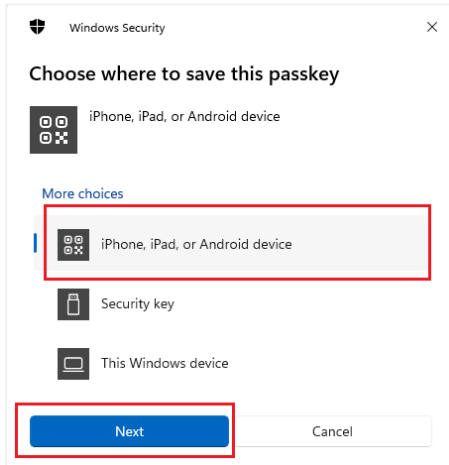

7. Scan the QR code with a smartphone to create the connection between the device and the computer



8. Add the Passkey record to the smartphone.

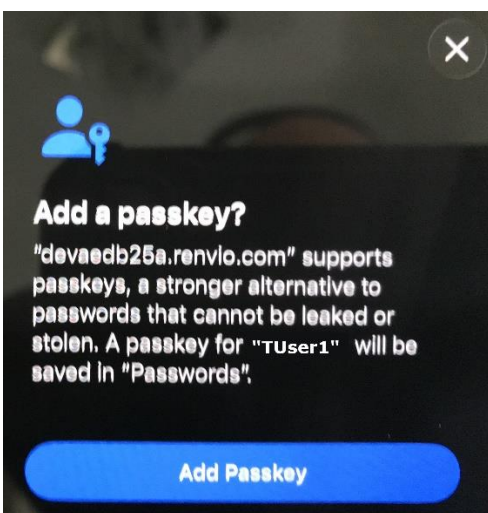



9. A confirmation message will display about smartphone connected to the application.



10. The new passkey will be displayed in the grid view.

Manage PassKeys

Sign in method that replaces traditional passwords. Users authenticate using their device-such as a fingerprint, face recognition or a device PIN.

	Device Name	Created	Last Used
 	TUser1	03/05/2026	03/05/2026

[Add](#)

Passkey Login

1. Click on "Log in with PassKey" button.

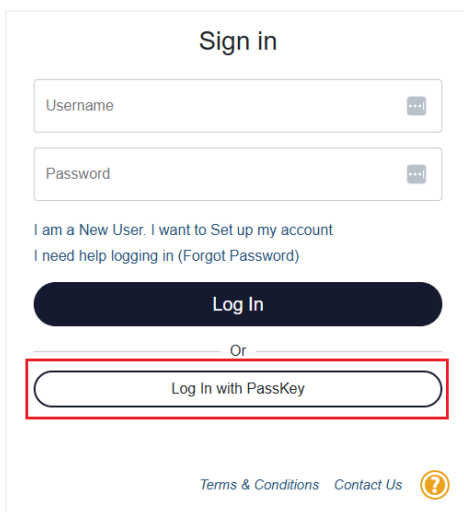

2. Click on "Next" button

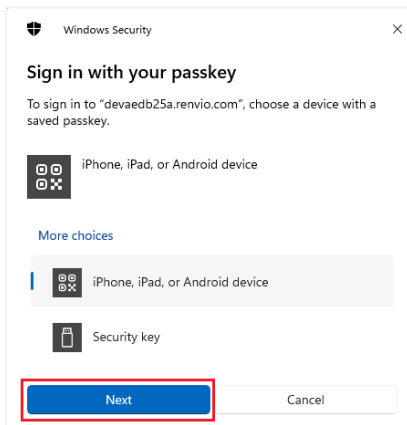

3. Scan the QR code for validation of the existing Passkey



4. Use the Passkey for login into the application.

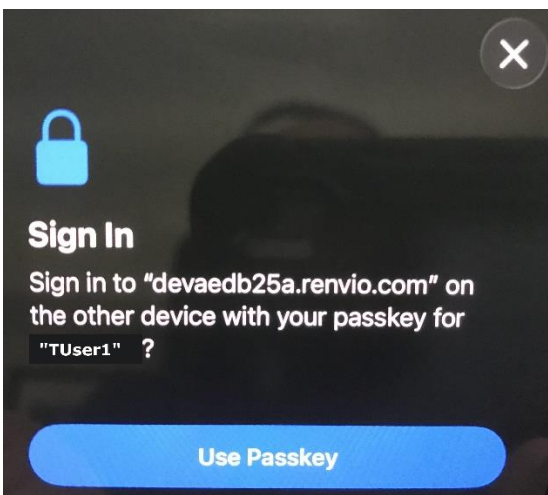

5. A confirmation message will display about smartphone connected to the application

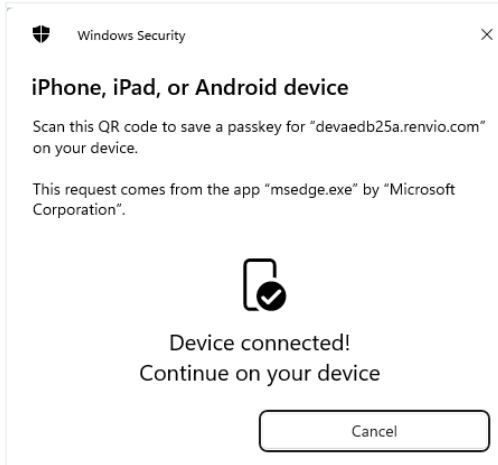

6. The application will display the home page.

